

# Smart Watering Kit

## User Manual

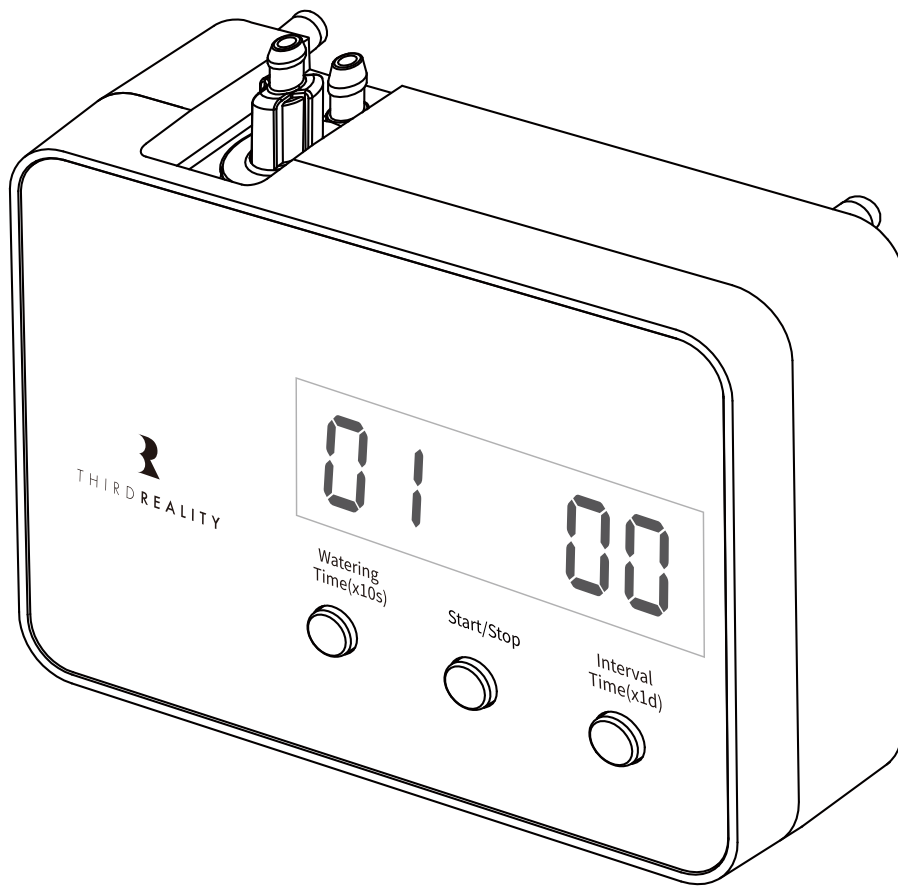

THIRD REALITY

# Contents

What' s in the Box .....	01
Programming.....	02
LED Indicator .....	03
Specifications .....	03
Using Case .....	03
Installation and Quick Start .....	04
Setup with Smart Bridge MZ1 .....	06
Setup with Third Reality Hub and SKILL .....	09
Setup with Compatible Third-Party Zigbee Hubs .....	11
Pairing with SmartThings .....	12
Pairing with Homey .....	14
Pairing with Amazon Alexa .....	17
Pairing with Hubitat .....	20
Pairing with Home Assistant .....	23
FCC Regulatory Conformance .....	28

# What's in the Box

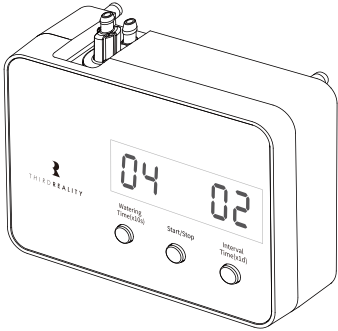

Smart Watering Kit × 1

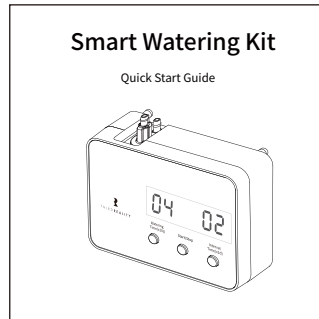

User Manual × 1



Tube × 1 (3 m)

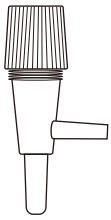

Water Dropper × 2



Stake × 2

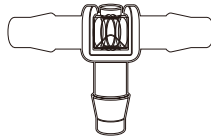

T-Joint × 1



Filter × 1



AA Battery × 4

# Programming

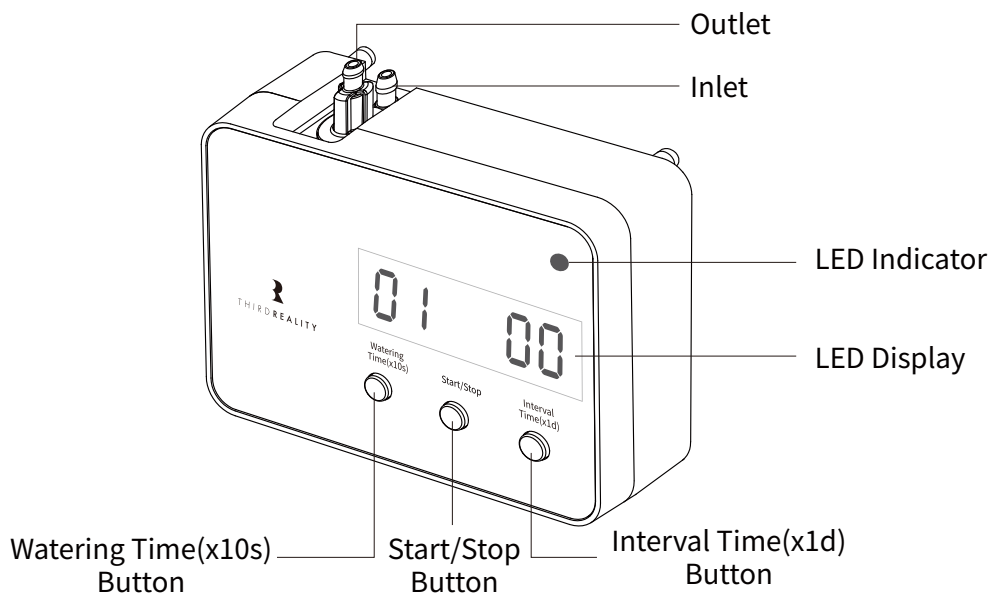

- ① [LED Display]: Press any button to wake up the digital screen.
- ② [Watering Time]: Press the Watering Time(x10s) Button, the time unit is 10 seconds(01 x 10s) - 990 seconds (99 x 10s), 00 x 10s indicates 1,000 seconds, this can be customized from 1 to 1,800 seconds through the 3R-Installer App (Smart Bridge required).
- ③ [Watering Interval]: Press the Interval Time(x1d) Button, the time is 1 day - 30 days, 00 indicates no routine.
- ④ [Customizable Time]: Set the watering time to 0 and interval time to 0, then set the schedule through your smart home automation system.
- ⑤ [Pairing]: Press and hold the Start/Stop Button until the LED Indicator turns red, release the hold, the LED Indicator turns fast blue blinking indicating the device enters Zigbee pairing mode.
- ⑥ [Start/Stop Watering]: Press the Start/Stop Button to start/stop watering.

# LED Indicator

LED Status	Description
Blue blinking	Pairing
Red slow blinking	Offline
Red double blinking	Low Battery

## Specifications

Name	Smart Watering Kit
Model	3RWK0148Z
Operating Voltage	DC 6V
Battery Type	4 x AA battery
Watering Time (x 10s)	10 seconds(01 x 10s, default) - 990 seconds (99 x 10s) 00 x 10s indicates 1,000 seconds (customizable from 1 to 1,800 seconds)
Interval Time (x 1d)	1 day(01 x 1d) - 30 days(30 x 1d), default 00 no routine
Wireless Connectivity	Zigbee 3.0
Working Condition	-10 - 40 °C (Indoor Use)
Flow Rate	Max up to 7 ml/s

## Using Case

1. You could connect your Smart Watering Kit to your smart home setup.
2. To create a routine, please set the “Interval Time(x1d)” to “00” to enable the routine control from the app.
3. Then set the “Watering Time(x10s)” locally as you desired, “01” represents that the pump will work for 10 seconds.

We strongly recommend doing a test run first to see how much water a plant will receive, especially when you are watering multiple plants.

# Installation and Quick Start

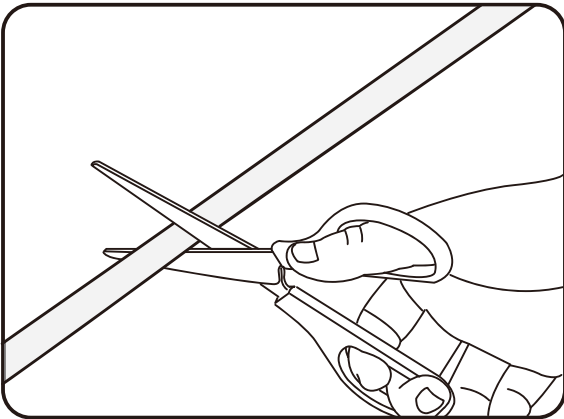

- 1 Cut the tube to the required length.

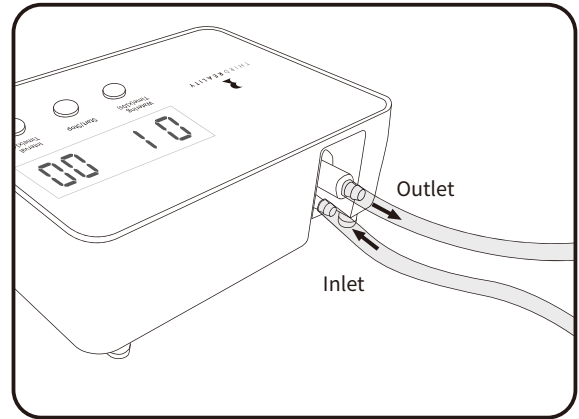

- 2 Connect the two tubes to the water inlet, and outlet respectively.

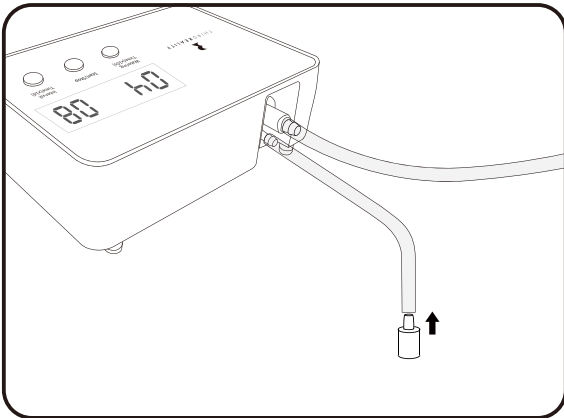

- 3 Install the filter to the tube.

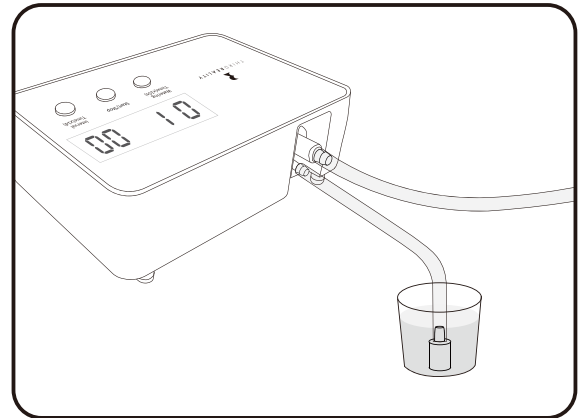

- 4 Put it in the water tank.

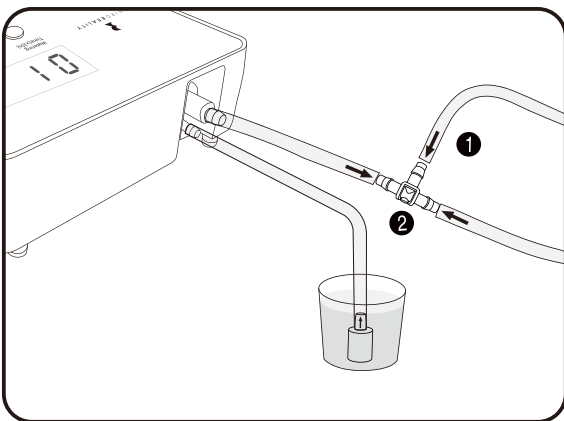

- 5 The T-joint can be used to connect more water tubes.

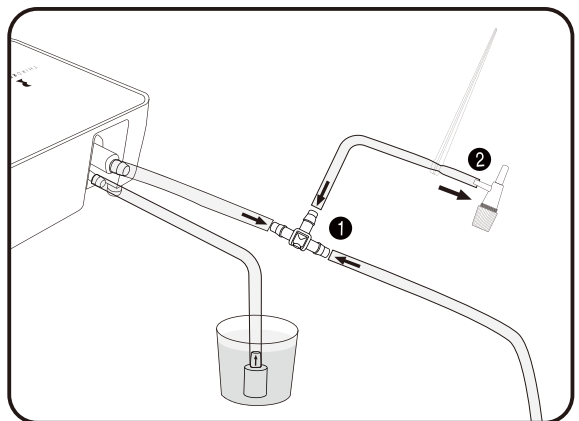

- 6 Install the water dropper and stake to the end of the tube.

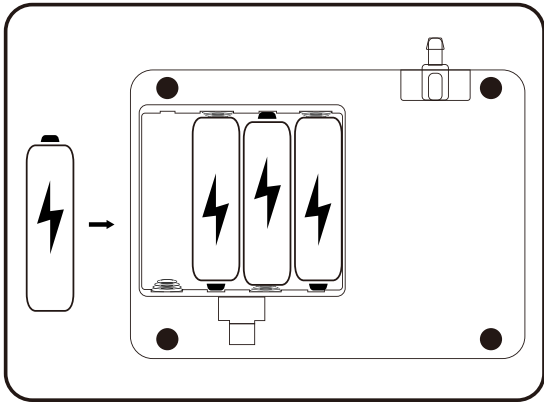

**7** Install the batteries.

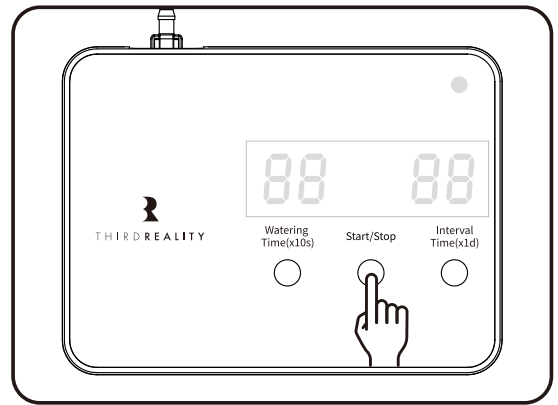

**8** Press any button to turn on the LED display.

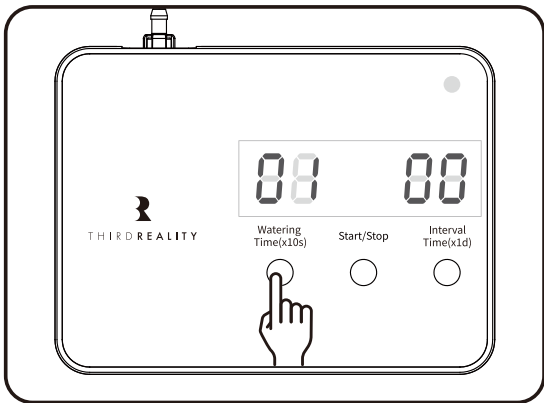

**9** Press [Watering Time(x10s)] button to set the watering duration from 10s to 990s.

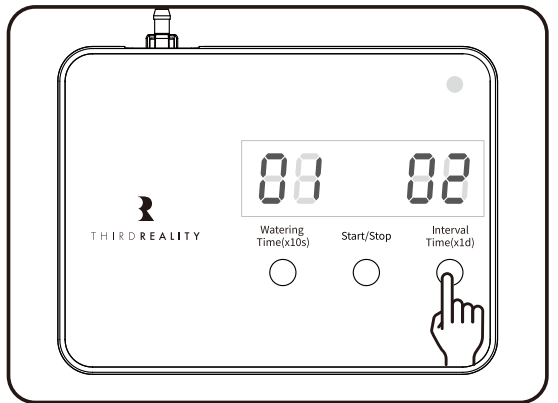

**10** Press [Interval Time (x1d)] button to configure the watering schedule from 1 day to 30 days.

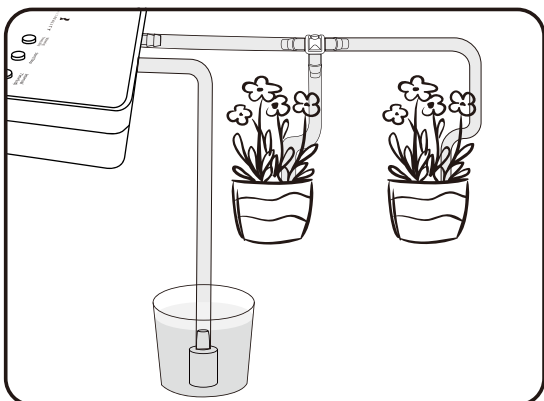

**11** The device is set up successfully and it's ready to water plants automatically.

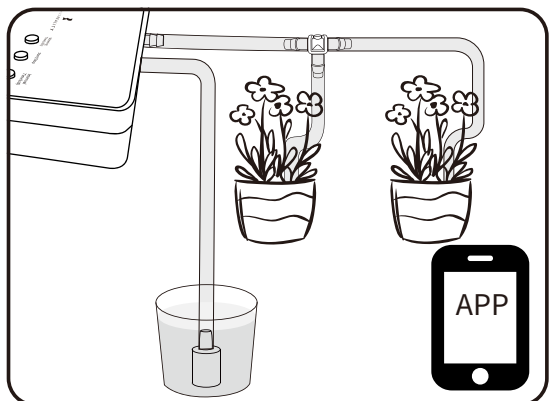

**12** You can also set up the smart watering kit with your Zigbee hub/bridge.

# Setup with Smart Bridge MZ1

The Smart Bridge (sold separately) enables your Zigbee device to become Matter-compatible, allowing seamless integration with major Matter ecosystems like Apple Home, Google Home, Amazon Alexa, Samsung SmartThings, and Home Assistant. Third Reality also offers the 3R-Installer App, which let you configure its various attributes and perform firmware updates.

1. Ensure your bridge is already set up within your smart home system.
2. Install the battery to power on the smart watering kit and confirm it's in pairing mode. Otherwise, please press and hold the start/stop button for 5 seconds to factory reset the smart watering kit to initiate pairing mode.
3. Press the pinhole button on the smart bridge to activate Zigbee pairing mode. The Zigbee blue LED should start blinking.
4. The smart watering kit will be added to your smart bridge, and a new device will appear in your smart home app, such as Apple Home, Google Home or Alexa.
5. Optionally, you can install the 3R-Installer App and use the multi-admin feature in your smart home app to share permissions with the 3R-Installer App.

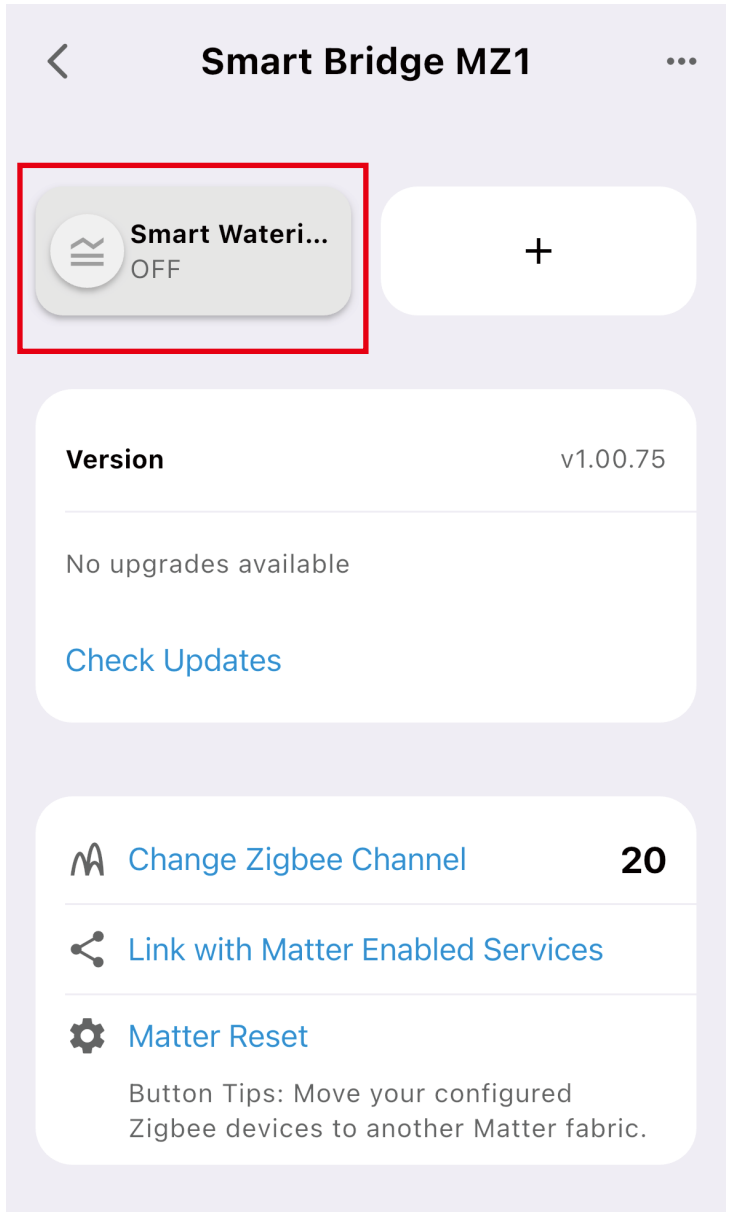
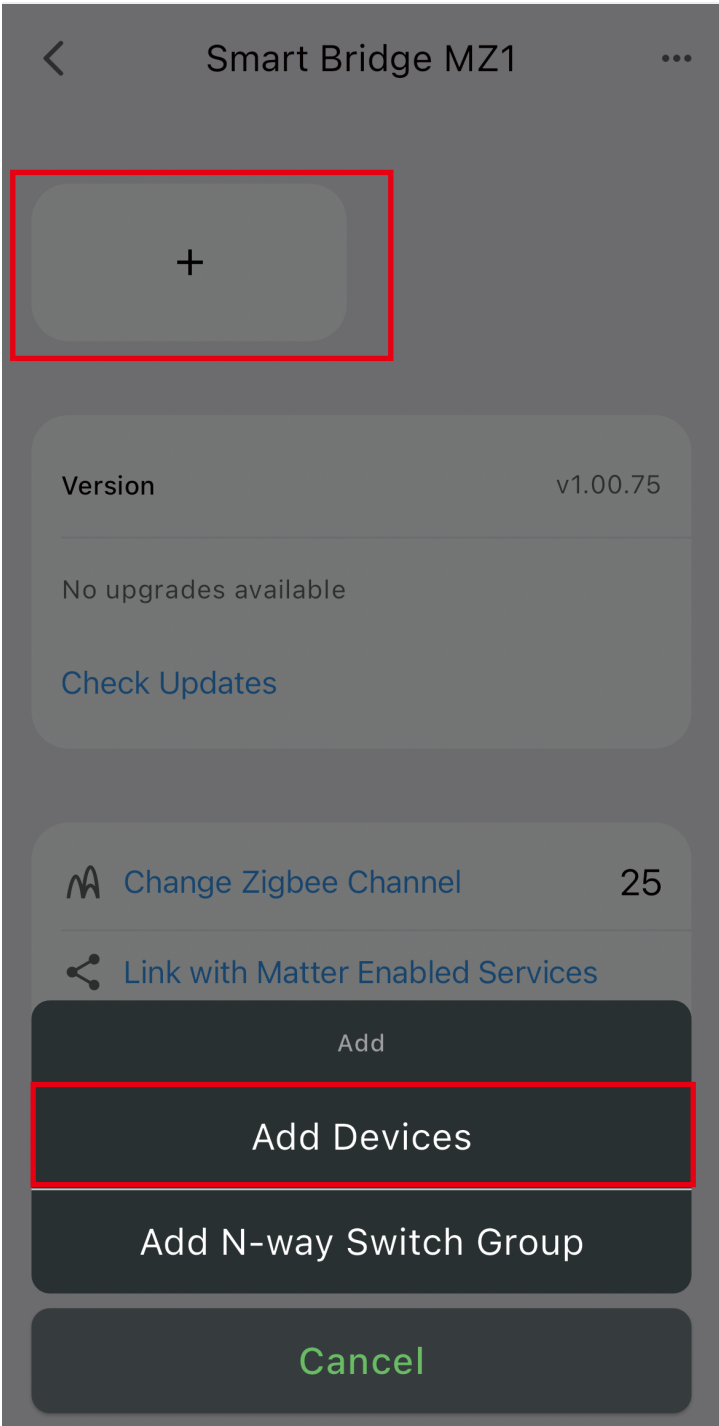
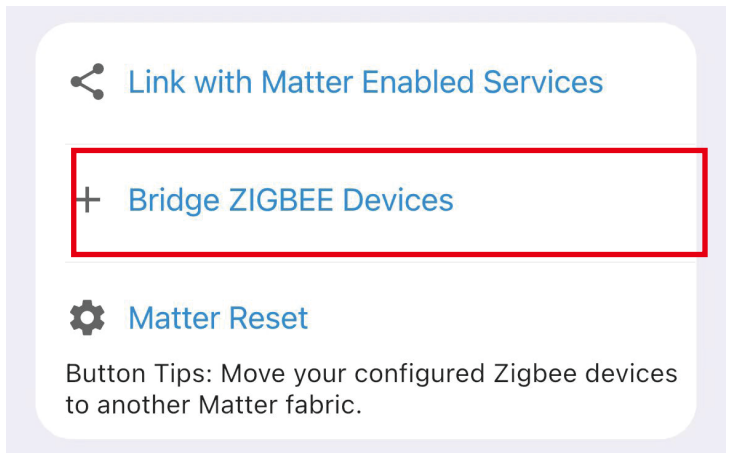
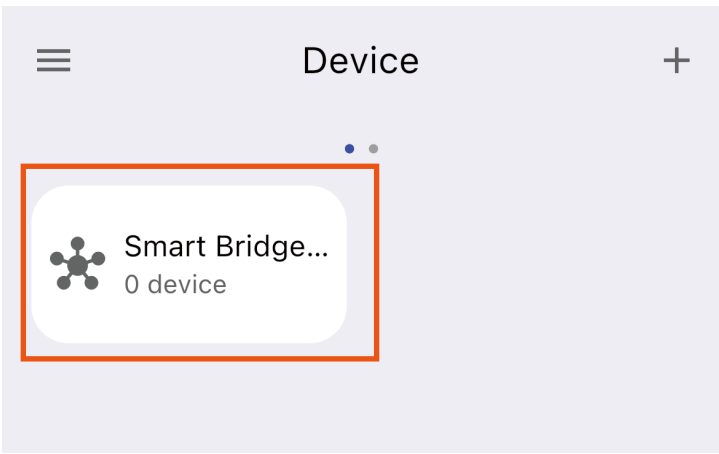

Smart Watering Kit

OFF

Battery 27%

Version v1.00.26

No upgrades available

[Check Updates](#)

Change Zigbee Channel 20

**Link with Matter Enabled Services**

Matter Reset

Button Tips: Move your configured Zigbee devices to another Matter fabric.

Link with Manual Setup Code or Scan the QR Code

Effective duration: 2 minutes 54 seconds

1324-192-6558



Done

# Setup with Third Reality Hub and SKILL

The Third Reality Hub (sold separately) allows you to control your device remotely via the Third Reality App, making it a great option for smart home beginners or those without a system from major providers. Additionally, the Third Reality Cloud supports SKILL integration with Google Home or Amazon Alexa, enabling you to connect your device to these platforms. However, due to the potential for slow and unreliable Cloud-to-Cloud connections, we recommend using the Bridge solution if Google Home or Alexa is your primary smart home platform.

1. Ensure your hub is properly set up with Third Reality App.
2. Install the battery to power on the smart watering kit and confirm it's in pairing mode. Otherwise, please press and hold the start/stop button for 5 seconds to factory reset the smart watering kit to initiate pairing mode.
3. Open the Third Reality App, press the “+” icon next to the hub, and select “Quick Pair.”
4. The smart watering kit will pair with your hub and appear in the Third Reality App.
5. Optionally, you can enable the Third Reality SKILL in either the Alexa or Google Home app to enable Cloud-to-Cloud communication.

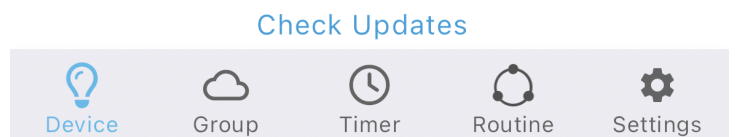
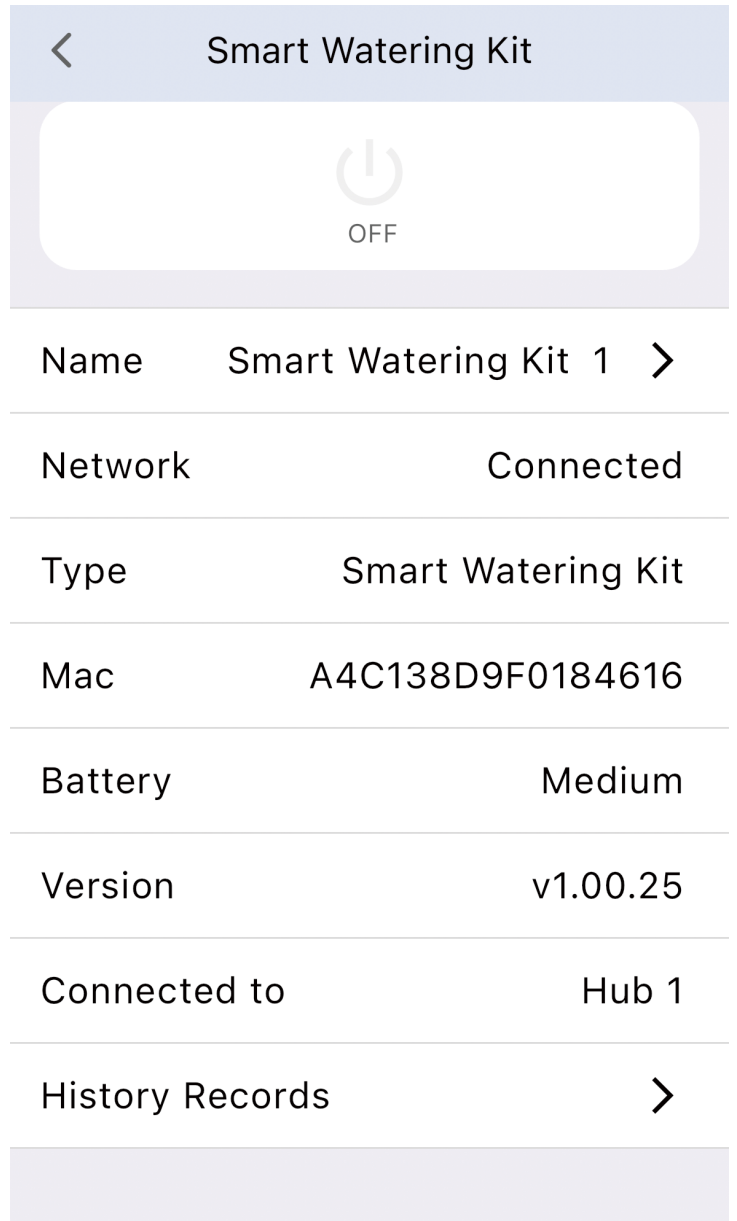
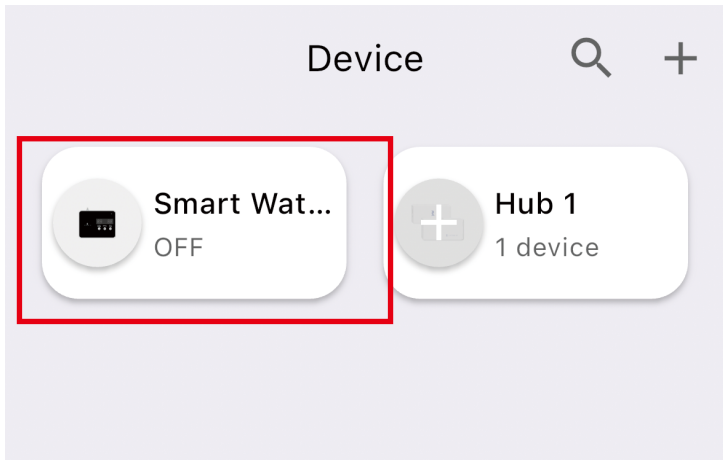
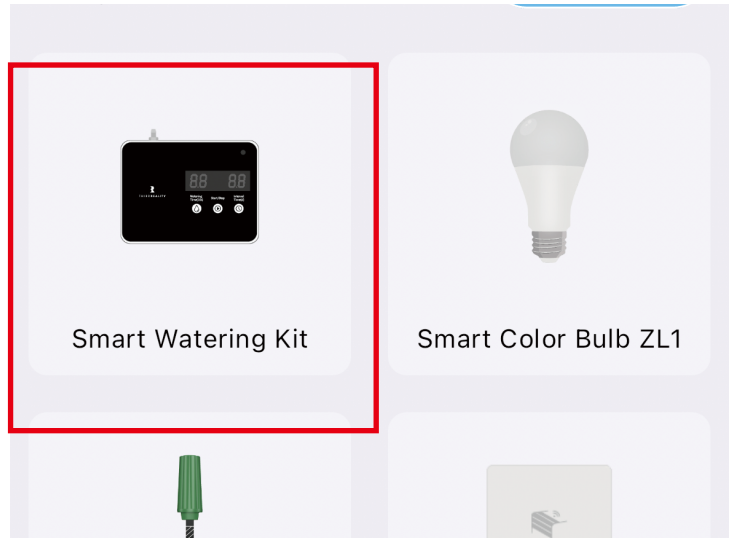
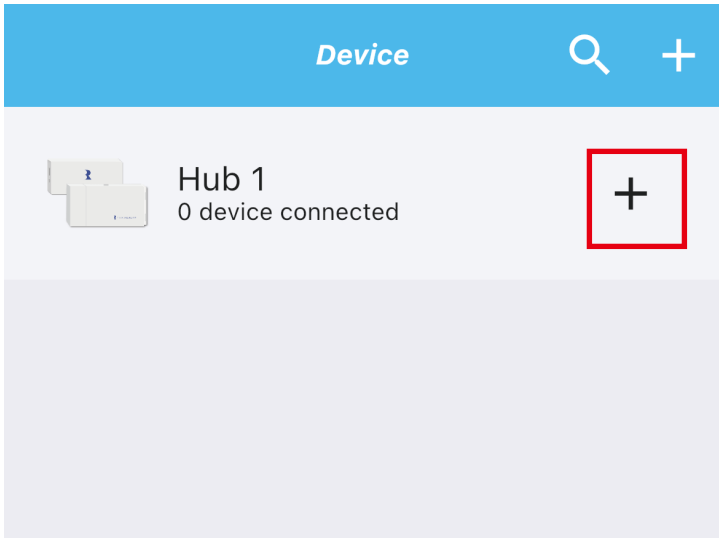

# Setup with Compatible Third-Party Zigbee Hubs

Third Reality supports integration with various open Zigbee platforms, including Amazon Echo with built-in Zigbee, SmartThings, Home Assistant (with ZHA or Zigbee2mqtt), Homey and Hubitat. If you own any of these devices, you can pair the smart watering kit directly without the need for an additional bridge or hub.

1. Ensure your Zigbee Hub has been already set up within your smart home system.
2. Install the battery to power on the smart watering kit and confirm it's in pairing mode. Otherwise, please press and hold the start/stop button for 5 seconds to factory reset the smart watering kit to initiate pairing mode.
3. Open your smart home app and follow the on-screen instructions to begin the Zigbee pairing process.
4. The smart watering kit will be paired with the Zigbee hub.
5. Use your smart home app to turn on/off the smart watering kit, create routines to water your plant in schedule.

# Pairing with SmartThings

App: SmartThings App

Devices: SmartThings Hub 2nd Gen(2015) and 3rd Gen(2018), Aeotec Smart Home Hub.



## Pairing steps:

1. Before pairing, check for updates to make sure the SmartThings Hub firmware is up to date.
2. Install the battery to power on the smart watering kit and confirm it's in pairing mode. Otherwise, please press and hold the start/stop button for 5 seconds to factory reset the smart watering kit to initiate pairing mode.
3. Open your SmartThings App, tap “+” on the up right corner to ”Add device” and then tap “Scan nearby”.

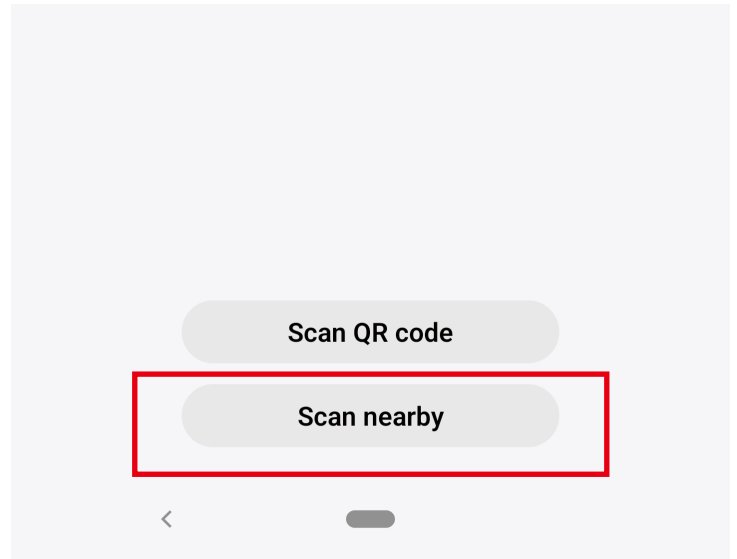
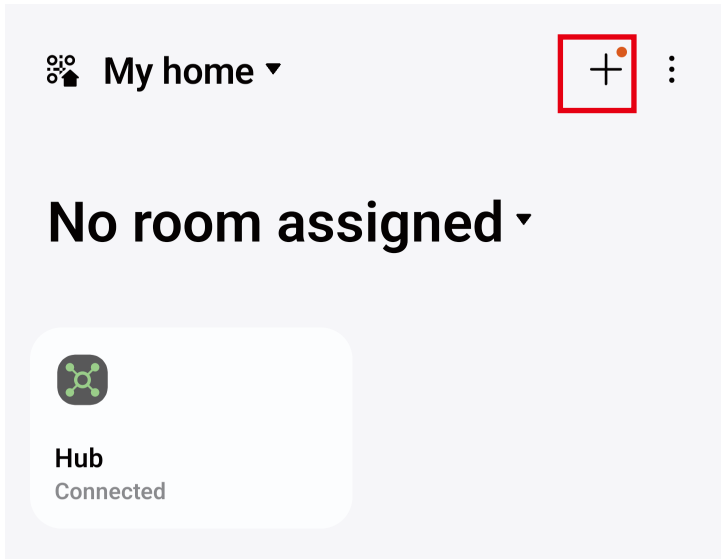

4. The bulb will be added to your SmartThings hub in a few seconds.

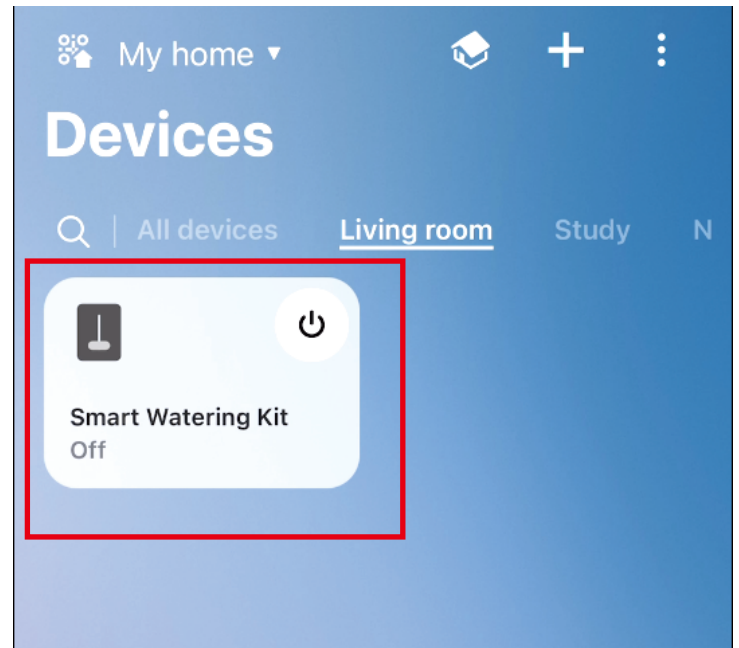
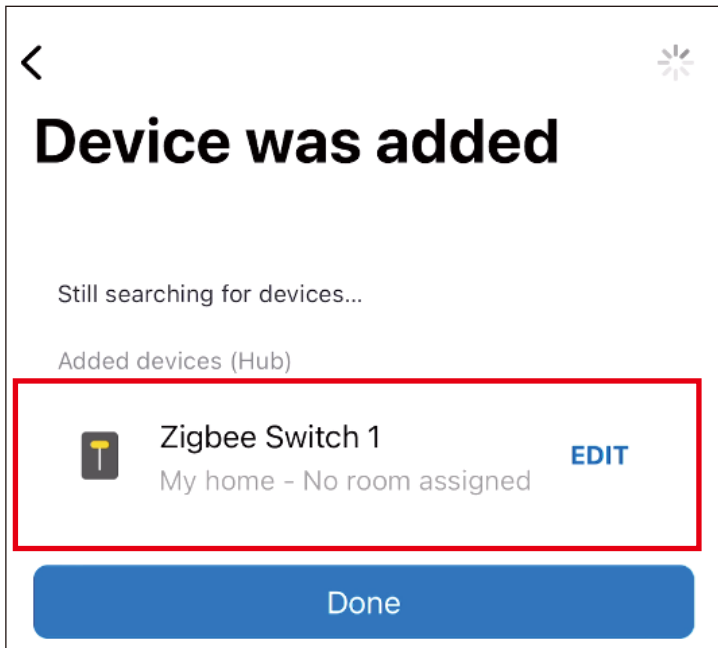

5. Create routines to control connected devices.

# Pairing with Amazon Alexa

App: Amazon Alexa

Devices: Echo speakers with built-in Zigbee hub, Echo 4th Gen, Echo Plus 1st & 2nd Gen, Echo Studio



## Pairing steps:

1. Ask Alexa to check for updates before pairing.
2. Install the battery to power on the smart watering kit and confirm it's in pairing mode. Otherwise, please press and hold the start/stop button for 5 seconds to factory reset the smart watering kit to initiate pairing mode.
3. Tap "+" in the Alexa App, choose "Other" and "Zigbee" to add device, the smart watering kit will be added.
4. You can create routines with the device.

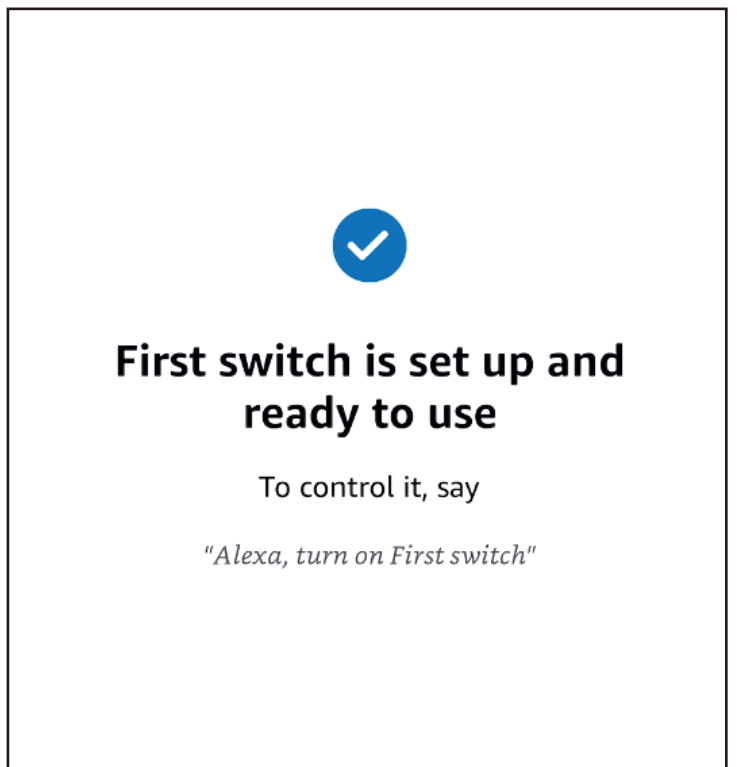
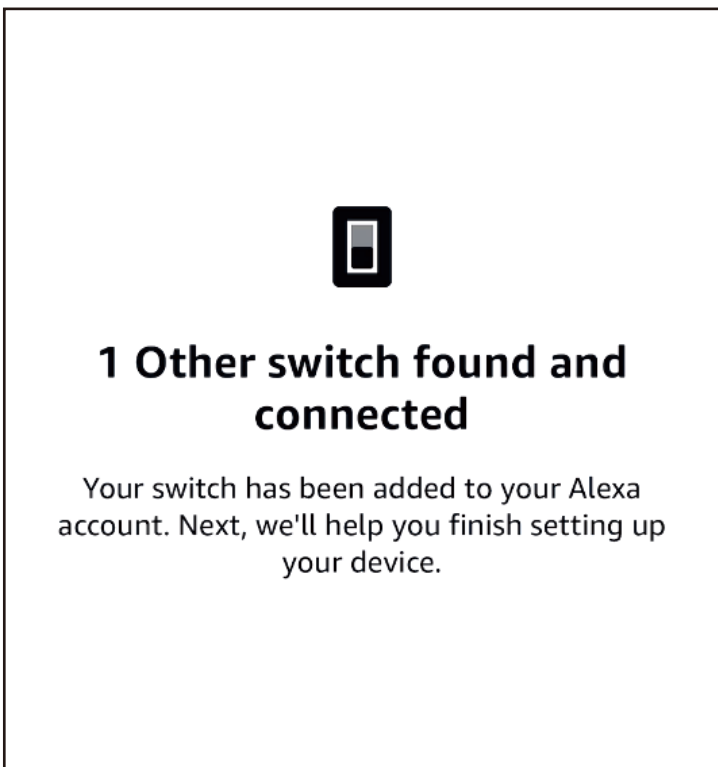
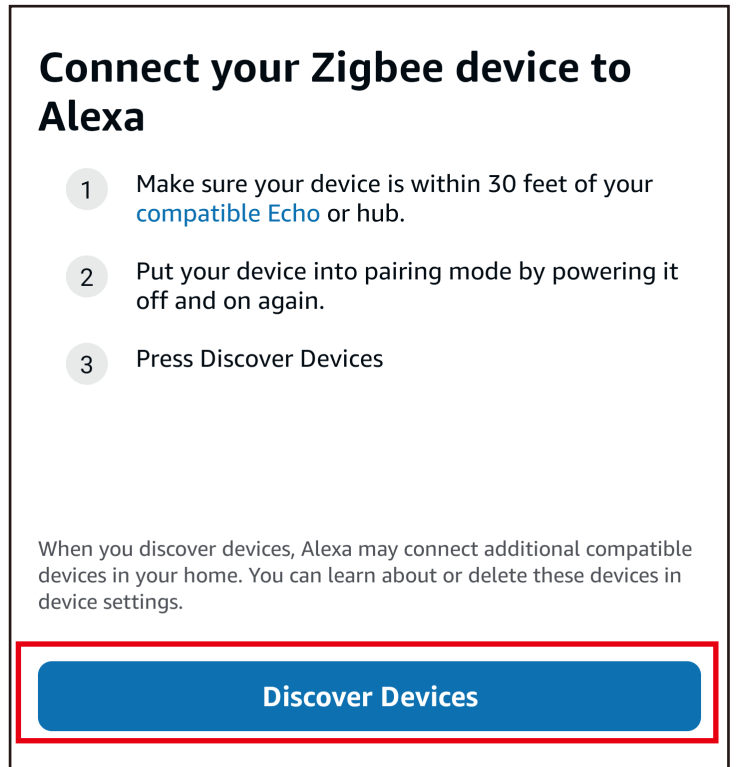
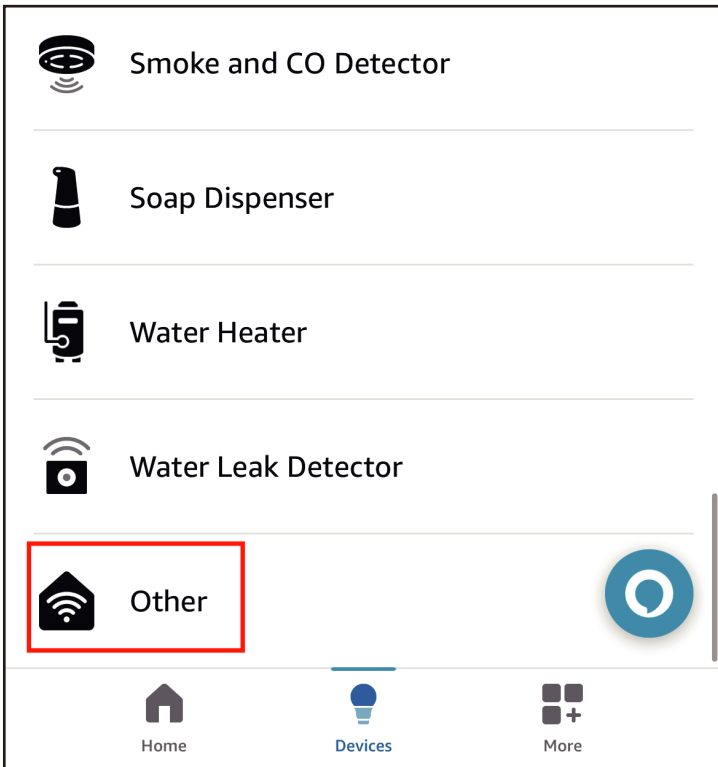
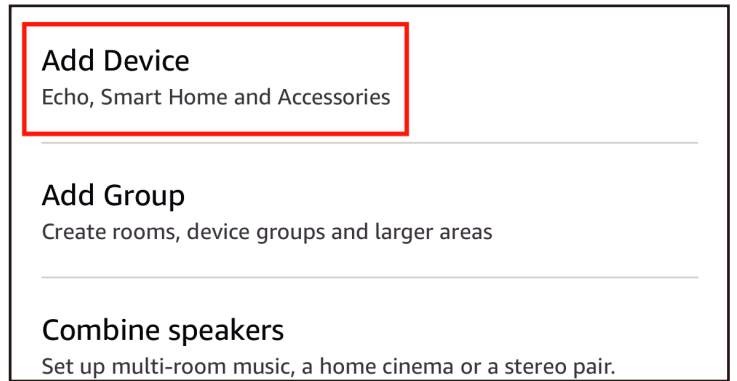
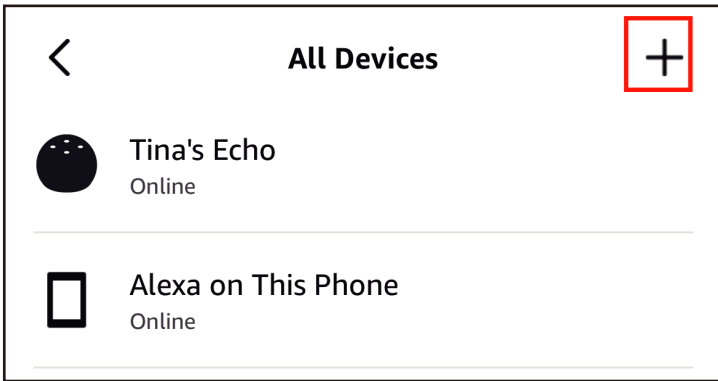

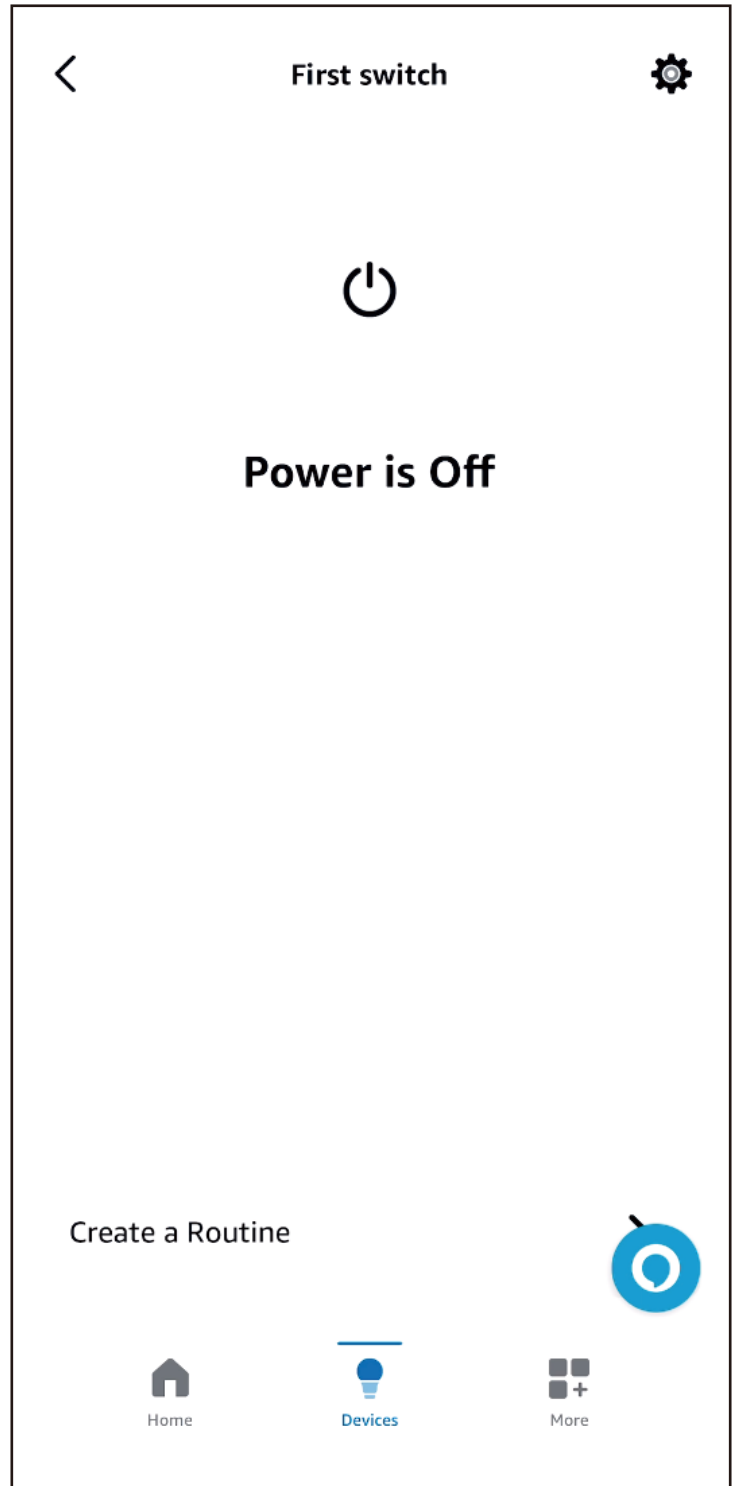
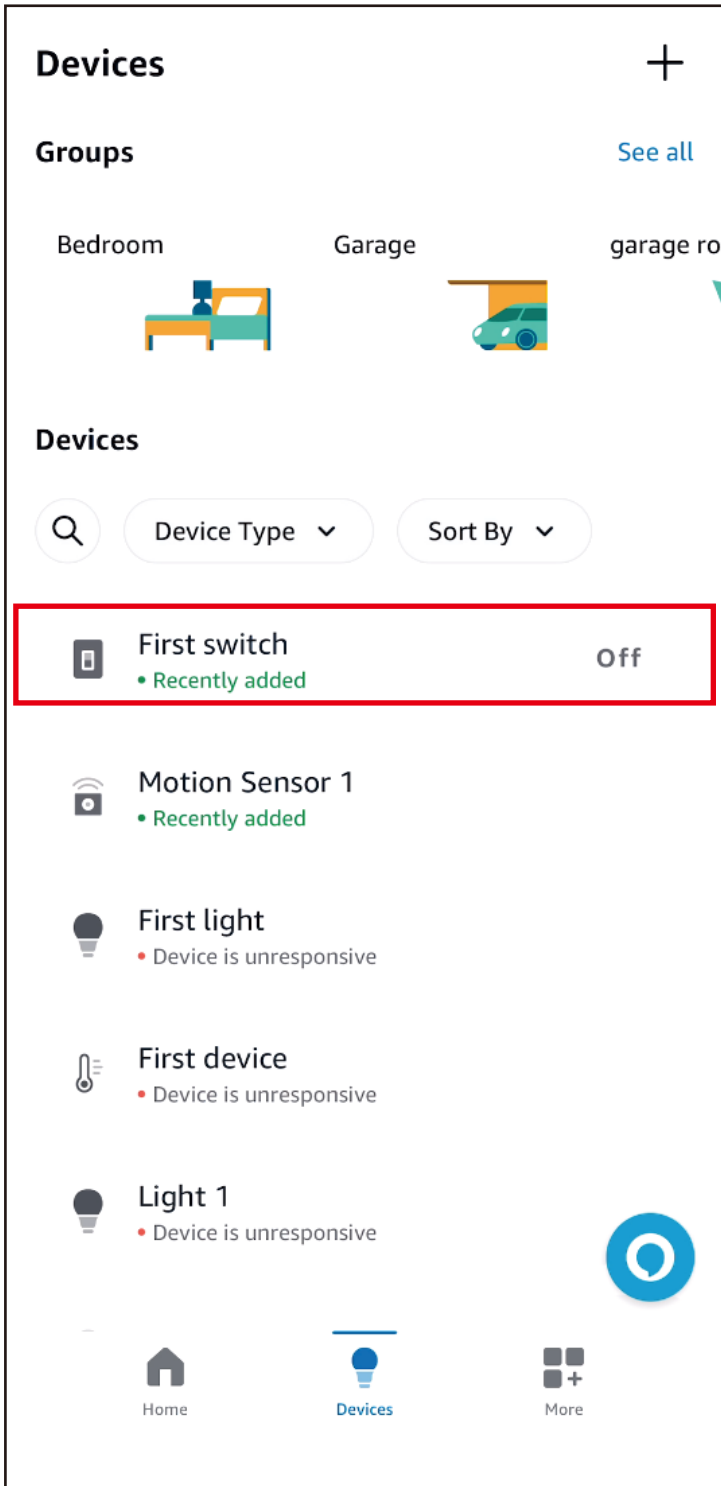

# Pairing with Homey

App: Homey

Devices: Homey Pro, Homey Bridge



## Pairing steps:

1. Install the Third Reality App in your Homey App.
2. Install the battery to power on the smart watering kit and confirm it's in pairing mode. Otherwise, please press and hold the start/stop button for 5 seconds to factory reset the smart watering kit to initiate pairing mode.
3. Tap "+" in the Devices, tap → "New Device" → "Third Reality" → "Smart Watering Kit" → "Connect" and follow the instruction to add device.
4. Create a Flow with the Smart Watering Kit.

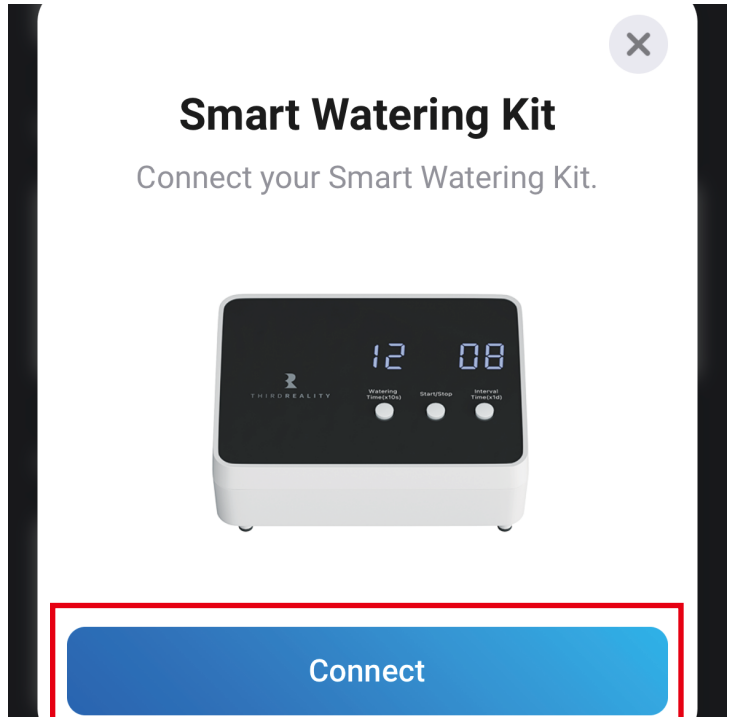
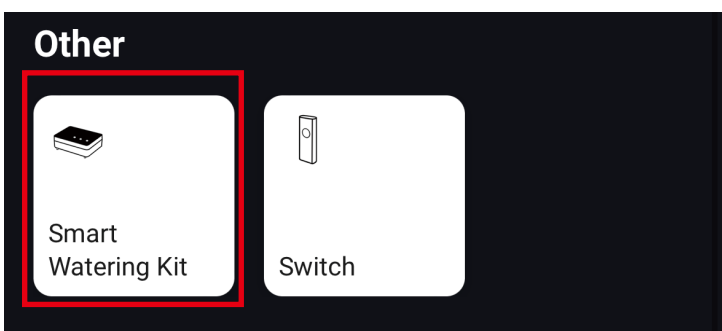
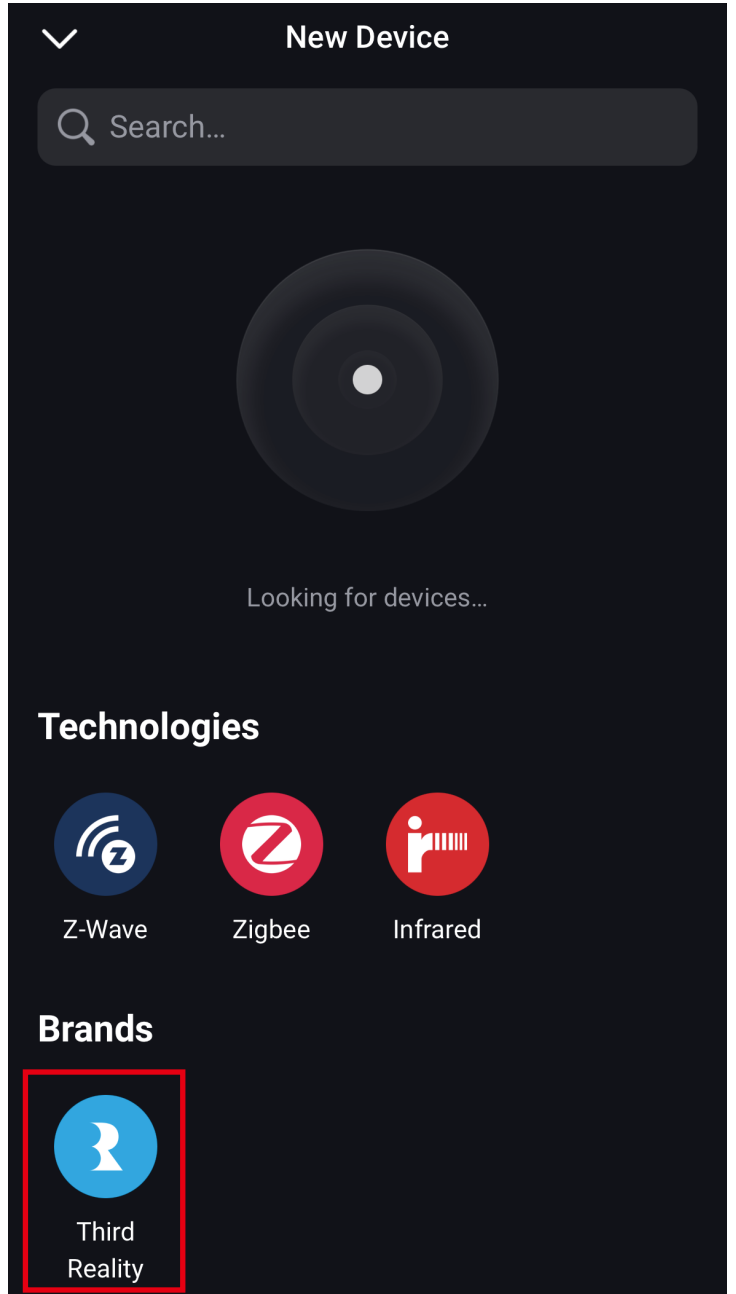
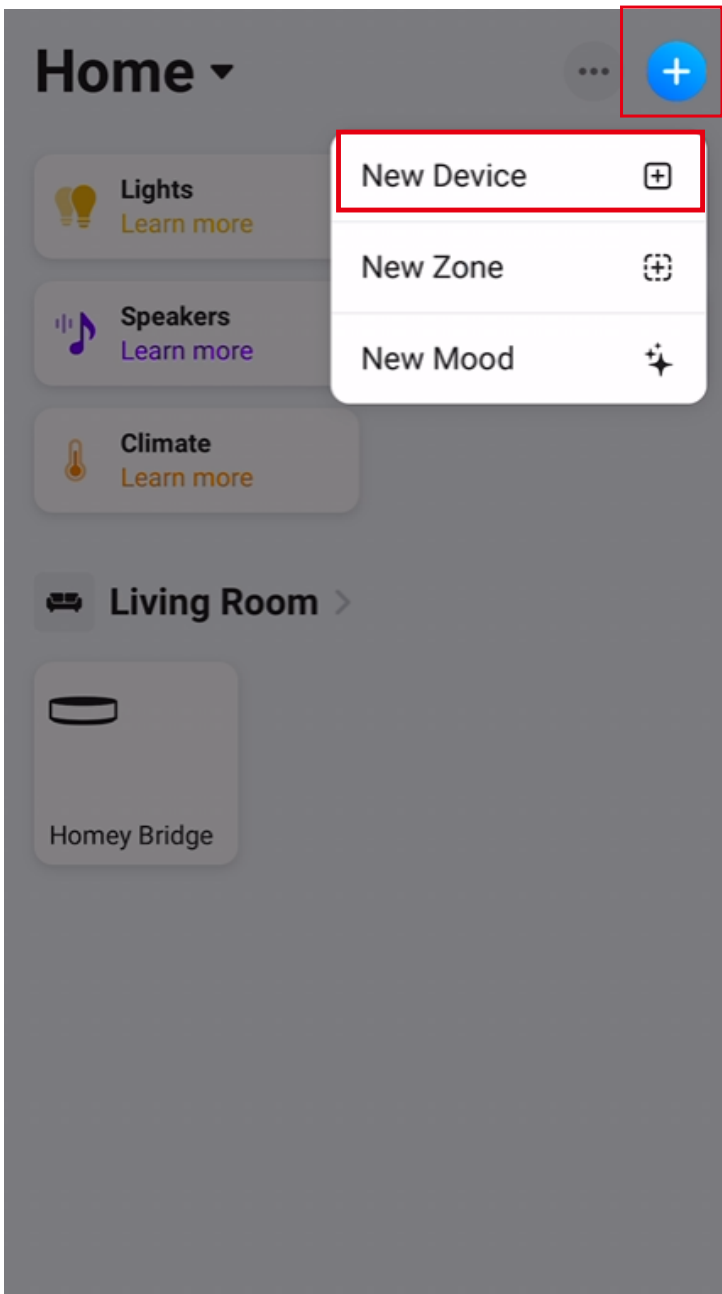

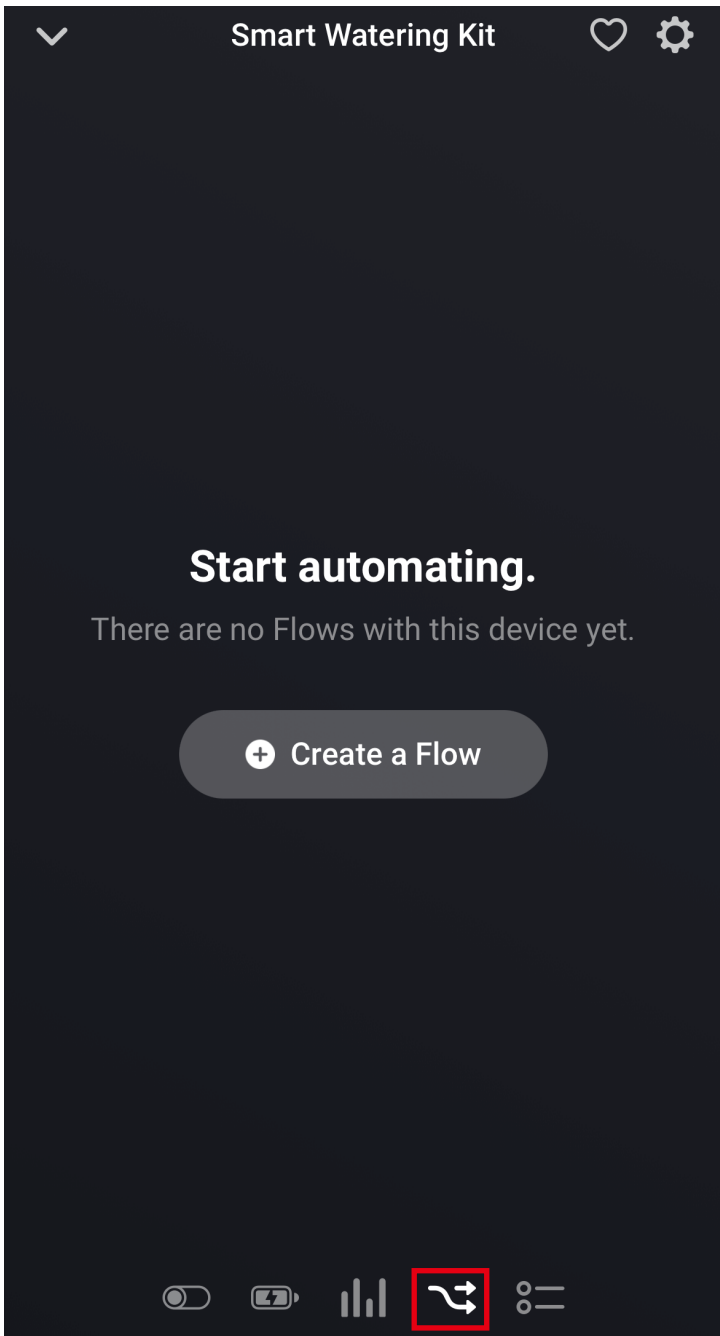
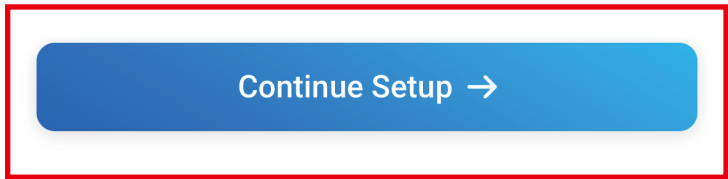
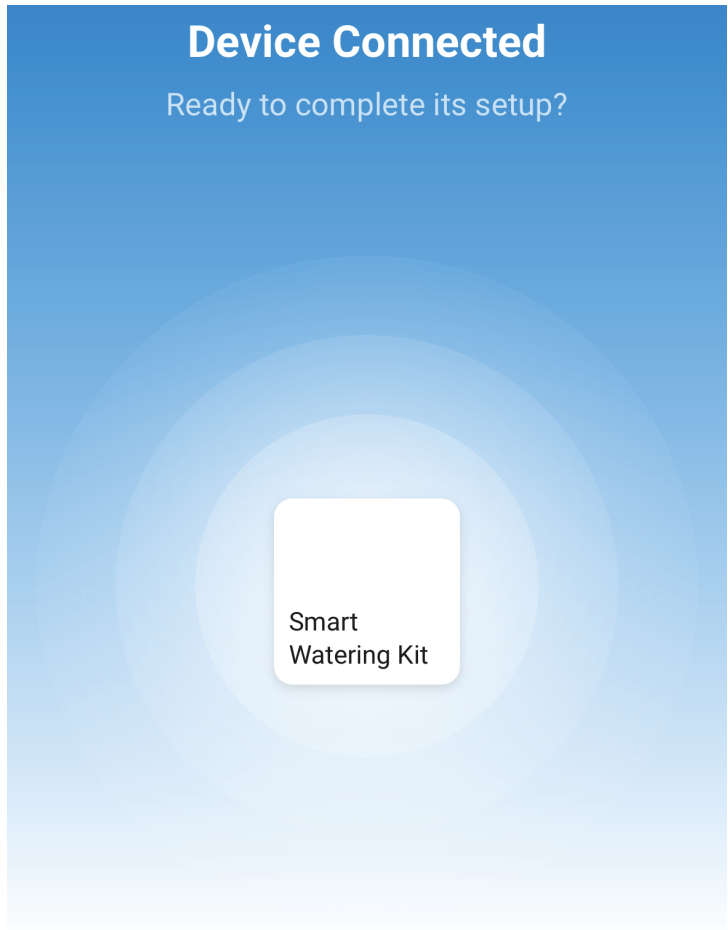
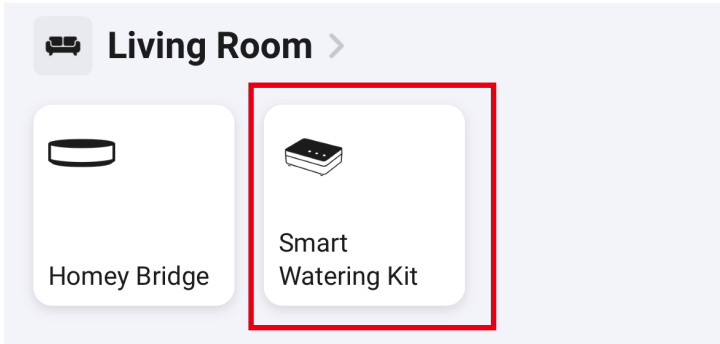
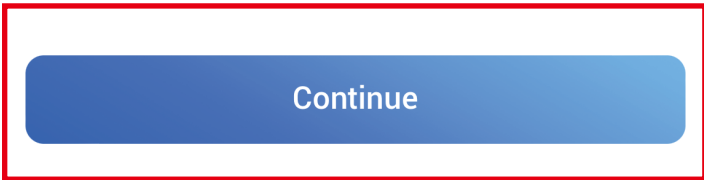

# Pairing with Hubitat

Website: <http://find.hubitat.com/>



## Pairing steps:

1. Install the battery to power on the smart watering kit and confirm it's in pairing mode. Otherwise, please press and hold the start/stop button for 5 seconds to factory reset the smart watering kit to initiate pairing mode.
2. Visit your Hubitat Elevation hub device page from your web browser, select the Devices menu item from the sidebar, then select Discover Devices in the upper right.
3. Click Start Zigbee Pairing button after you select a Zigbee device type, the Start Zigbee Pairing button will put the hub in Zigbee pairing mode for 60 seconds.
4. Pairing is completed.
5. Tap Apps, and Create New Basic Rules.

Hubitat **Devices** hubitat-c7

Compatible device list X Clear Search... + Add device

Disable	Label (Name)	Type	Room	Source	DNI	Status	Last Activity
<input type="checkbox"/>	1 (Advanced Zigbee CT Bulb)	Advanced Zigbee CT Bulb		System	2EA3 B40ECFD298B00000		8/27/2024 10:42:35
<input checked="" type="checkbox"/>	444 (Device)	Device	huan	System	1315 282C02BFFF909D1		
<input type="checkbox"/>	729ms (Generic Zigbee Motion Sensor (no temp))	Generic Zigbee Motion Sensor (no temp)		System	8439 282C02BFFF6379		7/29/2024 15:44:55 60
<input type="checkbox"/>	Advanced Zigbee CT Bulb	Advanced Zigbee CT Bulb		System	1AED B40ECFD32AAC0000		8/27/2024 10:42:28
<input type="checkbox"/>	d4l (Third Reality Smart Button)	Third Reality Smart Button		System	5A05 282C02BFFF38F45		8/06/2024 13:42:54 100
<input type="checkbox"/>	Plant Watering System	Generic Zigbee Switch		System	4F31 282C02BFFF900C0		8/27/2024 10:13:02
<input type="checkbox"/>	Smart Soil Moisture Sensor (Device)	Generic Zigbee Temperature/Humidity Sensor		System	952B A4C138EEDB829E73		

Documentation Community Videos FAQ Terms of Service Copyright 2018-2024 Hubitat, Inc

Hubitat **Add device** hubitat-c7

Find by device type  
Bulbs, dimmers, locks, outlets, switches...

Find by brand  
Aeotec, Bosch, Centralite, Dome, Ecolink...

Add device manually:

Zigbee  Z-Wave  Matter  Iris V1 Zigbee

Virtual

Documentation Community Videos FAQ Terms of Service Copyright 2018-2024 Hubitat, Inc

Hubitat **Add device** hubitat-c7

Home - Zigbee

Make sure that the device has been **factory reset**. Simply removing it from a previous mesh may not allow it to be joined. A factory reset will ensure it is discoverable.

Pairing, 90s remaining

Documentation Community Videos FAQ Terms of Service Copyright 2018-2024 Hubitat, Inc

Hubitat  
REDUCE YOUR ENVIRONMENT

Add device

TR\_SC\_HT

Home - Zigbee Cancel

Give your new Device a name:

Smart Watering Kit

Next > **Replace existing device** Pairing info

Rooms  
Devices  
Dashboards  
Apps  
Settings  
Subscriptions  
Developer tools  
Apps code  
Drivers code  
Libraries code  
Bundles  
Logs

Hubitat  
REDUCE YOUR ENVIRONMENT

Smart Watering Kit

TR\_SC\_HT

Preferences

Flash rate: 750ms

Enable debug logging:

Enable descriptionText logging:

Status attribute for Devices/Rooms: None

Save Preferences

Device Information

Device Name \* Device: Device Network Id \* 7144 [edit](#)

Device Label: Smart Watering Kit

Type \* **Generic Zigbee Switch**

Zigbee Id: A4C138859F8F5EB6

Room: No room assigned

Event history size, per event type (1-2000): 11

Hub Mesh enabled:

State history size, per attribute (1-2000): 30

Too many events alert threshold, per hour (100-2000): 300

Save Device

Rooms  
Devices  
Dashboards  
Apps  
Settings  
Subscriptions  
Developer tools  
Apps code  
Drivers code  
Libraries code  
Bundles  
Logs

# Pairing With Home Assistant

Device: Zigbee dongle



## Zigbee Home Automation

1. Install the battery to power on the smart watering kit and confirm it's in pairing mode. Otherwise, please press and hold the start/stop button for 5 seconds to factory reset the smart watering kit to initiate pairing mode.
2. In Zigbee Home Automation, go to “Configuration” page, click “integration”.
3. Then click the “Devices” on the Zigbee item, then click “Add Devices”.
4. Pairing completed.
5. Back to “Devices” page to find the sensor added.
6. Click to enter in the control interface to set the bulb.
7. Click “+” belongs to Automation and add trigger and actions.

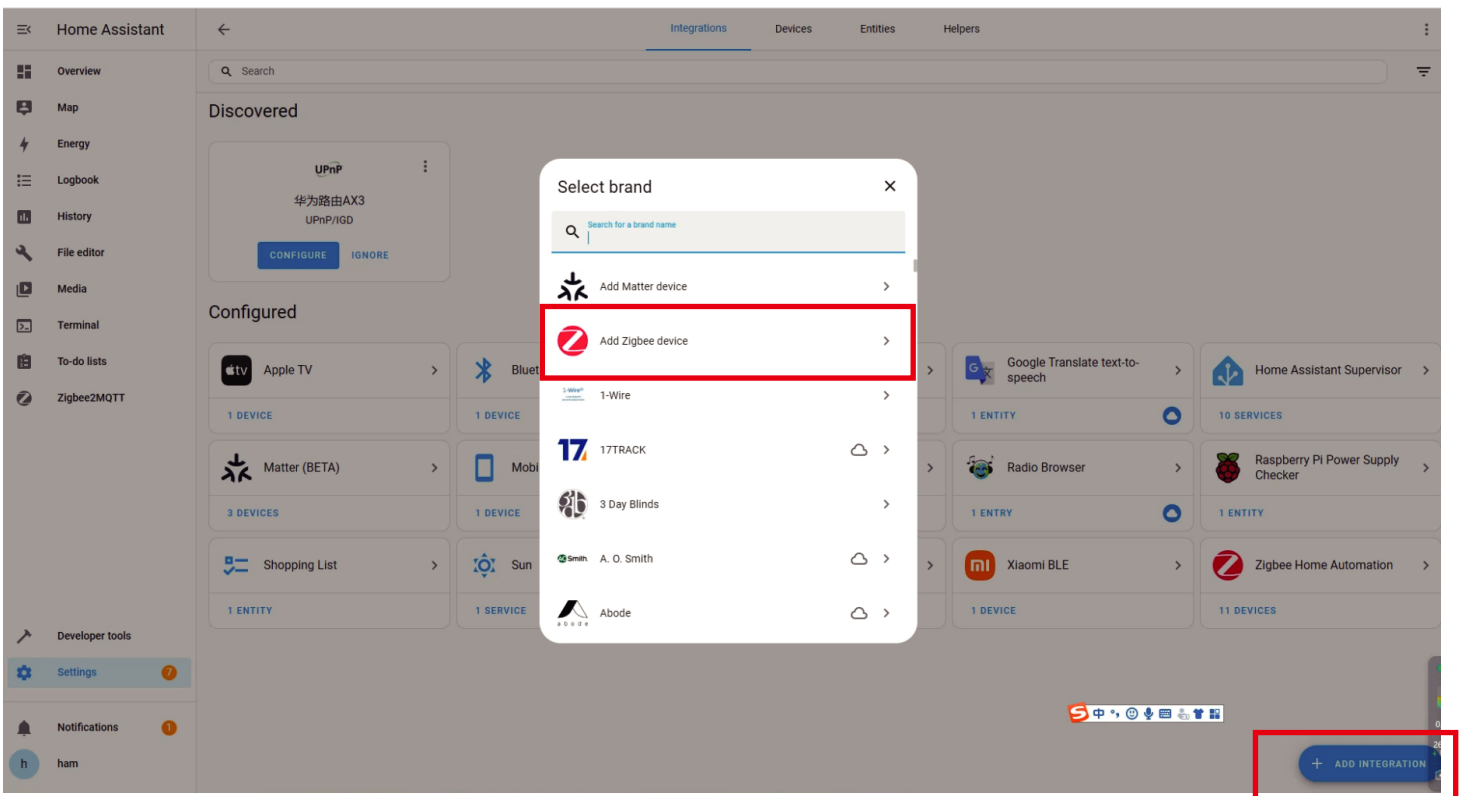
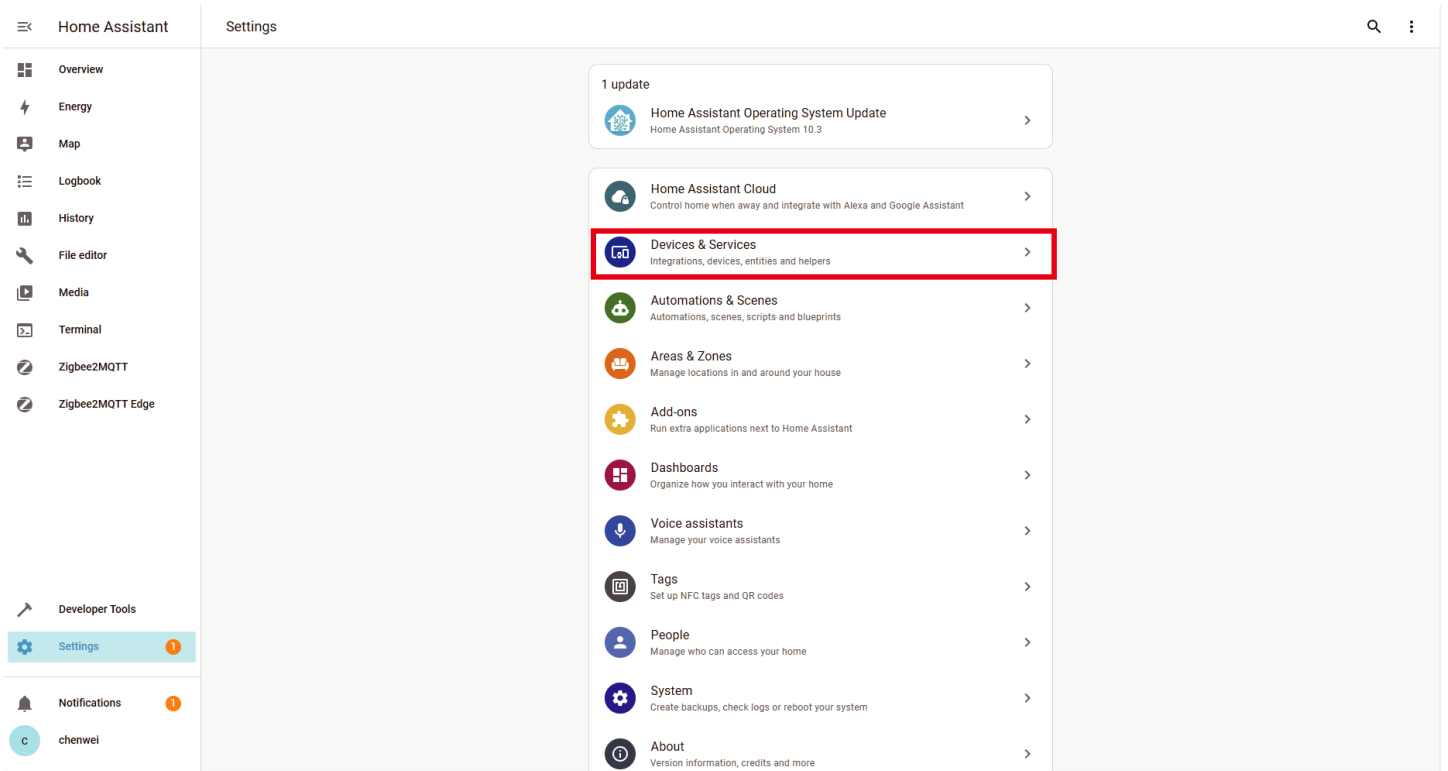

- Overview
- Map
- Energy
- Logbook
- History
- File editor
- Media
- Terminal
- To-do lists
- Zigbee2MQTT
- Developer tools
- Settings**
- Notifications
- ham

Filters Search 19 devices Group by Sort by Device

Device	Manufacturer	Model	Area	Integration	Battery
Third Reality, Inc 3RDS17BZ	Third Reality, Inc	3RDS17BZ	-	Zigbee Home Automation	-
Third Reality, Inc 3RDS17BZ	Third Reality, Inc	3RDS17BZ	-	Zigbee Home Automation	-
Third Reality, Inc 3RSM0147Z	Third Reality, Inc	3RSM0147Z	-	Zigbee Home Automation	-
Third Reality, Inc 3RSP02028BZ	Third Reality, Inc	3RSP02028BZ	-	Zigbee Home Automation	-
Third Reality, Inc 3RTHS24BZ	Third Reality, Inc	3RTHS24BZ	Living Room	Zigbee Home Automation	-
Third Reality, Inc 3RTHS24BZ	Third Reality, Inc	3RTHS24BZ	-	Zigbee Home Automation	100%
Third Reality, Inc 3RTHS24BZ	Third Reality, Inc	3RTHS24BZ	office	Zigbee Home Automation	-
Third Reality, Inc 3RTHS24BZ	Third Reality, Inc	3RTHS24BZ	-	Zigbee Home Automation	-
Third Reality, Inc 3RTHS24BZ	Third Reality, Inc	3RTHS24BZ	-	Zigbee Home Automation	-
Third Reality, Inc 3RTHS24BZ	Third Reality, Inc	3RTHS24BZ	-	Zigbee Home Automation	-
Third Reality, Inc 3RVS01031Z	Third Reality, Inc	3RVS01031Z	office	Zigbee Home Automation	94%
Third Reality, Inc 3RVS01031Z	Third Reality, Inc	3RVS01031Z	office	Zigbee Home Automation	91%
Third Reality, Inc 3RWK0148Z	Third Reality, Inc	3RWK0148Z	-	Zigbee Home Automation	74%

+ ADD DEVICE

- Overview
- Map
- Energy
- Logbook
- History
- File editor
- Media
- Terminal
- To-do lists
- Zigbee2MQTT
- Developer tools
- Settings**
- Notifications
- ham

74% zigbee

### Device info

3RWK0148Z  
by Third Reality, Inc  
Firmware: 0x00000019

Zigbee info

- Zigbee Home Automation

RECONFIGURE

### Controls

Switch

ADD TO DASHBOARD

### Configuration

Firmware Up-to-date

ADD TO DASHBOARD

### Diagnostic

Battery 74%

+2 entities not shown

ADD TO DASHBOARD

### Logbook

No logbook events found.

### Automations

No automations have been added using this device yet. You can add one by clicking the + button above.

### Scenes

No scenes have been added using this device yet. You can add one by clicking the + button above.

### Scripts

No scripts have been added using this device yet. You can add one by clicking the + button above.

# Zigbee2MQTT

1. Install the battery to power on the smart watering kit and confirm it's in pairing mode. Otherwise, please press and hold the start/stop button for 5 seconds to factory reset the smart watering kit to initiate pairing mode.
2. Permit join to start Zigbee pairing in Zigbee2MQTT.
3. Pairing completed, the smart watering kit will be displayed in the device list
4. Go to Settings page, create automation.

The screenshot shows the Home Assistant interface with the Zigbee2MQTT integration. The top navigation bar includes 'Home Assistant', 'Z2M@192.168.3.87', 'Devices', 'Dashboard', 'Map', 'Groups', 'OTA', 'Touchlink', 'Logs', and 'Extensions'. A 'Permit join (All)' button is highlighted with a red box. The main area displays a list of 33 devices with columns for ID, MAC address, Zigbee ID, Name, Manufacturer, Model, Battery level, and Status. The status column shows 'Third Reality' for devices 21-28 and 'Unsupported' for devices 26, 29-33.

ID	MAC	Zigbee ID	Name	Manufacturer	Model	Battery	Status
21	0x282c02bfffef4241	0x282c02bfffef4241 (0x3AD6)	Third Reality	3RSP02028BZ	N/A	↓	Third Reality
22	0x282c02bfffef914d	0x282c02bfffef914d (0x8574)	Third Reality	3RVS01031Z	N/A	↔	Third Reality
23	0xf4425000265d0000	0xf4425000265d0000 (0xc74E)	Third Reality	3RTHS0224Z	255	↔	Third Reality
24	0xb83dfb085bbe0000	0xb83dfb085bbe0000 (0x7193)	Third Reality	3RSNL02043Z	255	↓	Third Reality
25	0x282c02bfffef9563	0x282c02bfffef9563 (0x34FE)	Third Reality	3RVS01031Z	255	↔	Third Reality
26	0xa4c138bdcc79517	0xa4c138bdcc79517 (0xEE06)	Unsupported	3RSM0147Z	255	↓	Unsupported
27	0xf44250002ba10000	0xf44250002ba10000 (0x9F90)	Third Reality	3RTHS0224Z	255	↔	Third Reality
28	0x282c02bfffef8fad6	0x282c02bfffef8fad6 (0x3CA7)	Third Reality	3RSB228Z	210	↔	Third Reality
29	0xa4c138795f48c433	0xa4c138795f48c433 (0x8466)	Unsupported	3RWK0148Z	N/A	↓	Unsupported
30	0xa4c138678e6273cc	0xa4c138678e6273cc (0x95E7)	Unsupported	3RWK0148Z	N/A	↓	Unsupported
31	0xa4c138f3d050486b	0xa4c138f3d050486b (0x6DC3)	Unsupported	3RWK0148Z	N/A	↓	Unsupported
32	0xb40ecfd187d00000	0xb40ecfd187d00000 (0xA4EF)	Unsupported	3RCB01057Z	N/A	↓	Unsupported
33	0xa4c138051bb741bc	0xa4c138051bb741bc (0x8998)	Unsupported	3RSM0147Z	255	↓	Unsupported

Home Assistant

Z2M@192.168.3.87 Devices Dashboard Map Groups OTA Touchlink Logs Extensions Disable join (All) 03:51

22		0x282c02bfff914d	0x282c02bfff914d (0x8574)	Third Reality	3RV501031Z	N/A		
23		0xf4425000265d0000	0xf4425000265d0000 (0xc74E)	Third Reality	3RTH50224Z	255		
24		0xb83d085bbe0000	0xb83d085bbe0000 (0x7193)	Third Reality	3RSNL02043Z	255		
25		0x282c02bfff9563	0x282c02bfff9563 (0x34E9)	Third Reality	3RV501031Z	255		
26		0xa4c138dbcc79517	0xa4c138dbcc79517 (0xEE09)	Unsupported	3RSM0147Z	255		
27		0xf44250002ba10000	0xf44250002ba10000 (0x3F9D)	Third Reality	3RTH50224Z	255		
28		0x282c02bfff8fad6	0x282c02bfff8fad6 (0x2CA7)	Third Reality	3RSB228Z	210		
29		0xa4c138795f48c433	0xa4c138795f48c433 (0x8466)	Unsupported	3RWK0148Z	N/A		
30		0xa4c138678e6273cc	0xa4c138678e6273cc (0x95E7)	Unsupported	3RWK0148Z	N/A		
31		0xa4c138f3d050486b	0xa4c138f3d050486b (0x0C3)	Unsupported	3RWK0148Z	N/A		
32		0xb40ecfd187d00000	0xb40ecfd187d00000 (0xA4EF)	Unsupported	3RCB01057Z	N/A		
33		0xa4c138051bb741bc	0xa4c138051bb741bc (0x9998)	Unsupported	3RSM0147Z	255		
34		0xa4c138d9f0184616	0xa4c138d9f0184616 (0x7B3D)	Unsupported	3RWK0148Z	N/A		

Developer tools

Settings

Notifications

admin

Home Assistant

Z2M@192.168.3.87 Devices Dashboard Map Groups OTA Touchlink Logs Extensions Disable join (All) 03:25

0xa4c138d9f0184616 ▾

About Exposes Bind Reporting Settings Settings (specific) State Clusters Scene Dev console

**Battery** 73.5 %  
Remaining battery in %

**State** OFF ? ON  
On/off state of the switch

**Linkquality** 210   
Link quality (signal strength)

Developer tools

Settings

Notifications

admin

# FCC Regulatory Conformance

This device complies with part 15 of the FCC rules. Operation is subject to the following two conditions: (1) this device may not cause harmful interference, and (2) this device must accept any interference received, including interference that may cause undesired operation.

Changes or modifications not expressly approved by the party responsible for compliance could void the user's authority to operate the equipment.

NOTE: This equipment has been tested and found to comply with the limits for a Class B digital device, pursuant to part 15 of the FCC Rules. These limits are designed to provide reasonable protection against harmful interference in a residential installation.

This equipment generates uses and can radiate radio frequency energy and, if not installed and used in accordance with the instructions, may cause harmful interference to radio communications. However, there is no guarantee that interference will not occur in a particular installation. If this equipment does cause harmful interference to radio or television reception, which can be determined by turning the equipment off and on, the user is encouraged to try to correct the interference by one or more of the following measures:

- Reorient or relocate the receiving antenna.
- Increase the separation between the equipment and receiver.
- Connect the equipment into an outlet on a circuit different from that to which the receiver is connected.
- Consult the dealer or an experienced radio/TV technician for help important announcement.

NOTE: The manufacturer is not responsible for any radio or TV interference caused by unauthorized modifications to this equipment. Such modifications could void the user's authority to operate the equipment.

## RF Exposure

This equipment complies with FCC radiation exposure limits set forth for an uncontrolled environment.

This equipment should be installed and operated with minimum distance 20cm between the radiator and your body.

This transmitter must not be co-located or operating in conjunction with any other antenna or transmitter.

## Limited Warranty

For limited warranty, please visit <https://3reality.com/faq-help-center/>.

For customer support, please contact us at [info@3reality.com](mailto:info@3reality.com) or visit [www.3reality.com](http://www.3reality.com).

For question on other platforms, visit for corresponding platform's application/support platforms.